

# Polycarbonate Modular Flange System 1700 Product Drawings Last Updated 6/18/2008

Rose+Bopla Enclosures  
7330 Executive Way  
Frederick, MD 21704  
[www.rose-bopla.com](http://www.rose-bopla.com)  
[rbinfo@pm-usa.com](mailto:rbinfo@pm-usa.com)

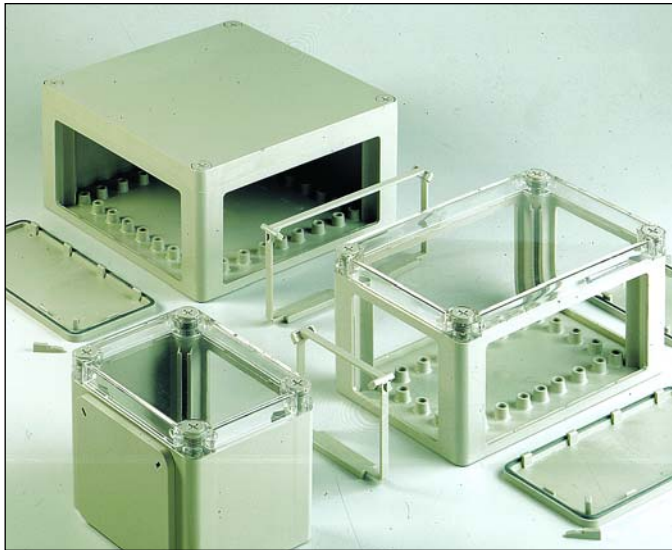

*Opaque lids are available in two depths, 20mm and 60mm, for the 1703, 1704, and 1705 models. 20mm lids are offered for the 1701 and 1702 version in both opaque and transparent. The new 1706 enclosure is available with 20mm lids in the standard material.*

#### **TECHNICAL DATA:**

- Material: Glass-filled Polycarbonate.
- Color: Gray, similar to RAL 7032.
- Impact resistance: 7 Nm, EN 50014 (except for pre-punched flanges).
- Flammability: Enclosure, Self-extinguishing, UL 94 VO.  
Transparent lid, UL 94 V2
- Surface resistance:  $>10^{15}$  Ohm, DIN 53481.
- Gasket: Neoprene Foam.
- Gasket Temperature Range:  $-40^{\circ}$  F to  $+212^{\circ}$  F.
- Protection Classification: NEMA 12  
IP 65 to EN 60529.
- Toxicity: Low halogen content.
- Weather Resistance: UV stabilized.
- Disruptive Strength: Enclosure,  $>18$  KV / mm to DIN 53481.  
Transparent lid,  $>30$  KV / mm to DIN 53481



**Polycarbonate 1700 Modular Flange with Clear Lid**

The Polycarbonate Modular Flange System is similar in design to our Fiberglass Modular Flange System in that these enclosures can be used as stand alone units or can be bolted together with

## **Polycarbonate Modular Flange**

connecting tunnel flanges and wedges. The Polycarbonate 1700 system features a greater range of sizes and is made of glass-filled Polycarbonate, a very economical material. One additional difference is that each Polycarbonate Modular Flange box is a complete enclosure unto itself, without the insertion of flanges.

The Polycarbonate Modular Flange System covers a broad spectrum of applications because they can be combined in so many ways. This system is ideal in applications where add-on capability or routine entry into the enclosure for maintenance is required. Some major benefits of this enclosure system are: they are very economical; they can be used in combination with any other modular polycarbonate flange enclosures; and working with the flanges is easy. The most common applications for Polycarbonate Flange enclosures are in the automotive industry, in electrical installations, and in areas where frequent rewiring is necessary.

The 1700 system consists of six different sizes of enclosures that can be used alone or connected together with tunnel adapters. Length and width dimensions are easily expandable by adding additional enclosures. Standard units, made of glass-filled polycarbonate, are UV stabilized to improve weather resistance and have a low halogen content which helps prevent the release of toxic halogenated gases when burned. The material brings strength, ruggedness, and weather/corrosion resistance to this very economical enclosure system. Our Polycarbonate Modular Flange enclosures have a NEMA 12 (IP 65) ingress protection rating and are mainly used indoors.

Each unit includes a base and a lid with a polyurethane foam gasket. All lids come with captive, quick-release, Phillips-head lid screws, also made of glass-filled Polycarbonate material. **Flanges, tunnel adapters, internal mounting plates (mounting plate drawings, page (17-81), internal mounting clips, internal mounting boss inserts, internal hinges, DIN Rails, external brackets, wedges and stainless steel grounding strips are sold separately as accessories.**

Every enclosure comes with molded-in partitions in the sidewalls that can be knocked-out to accept the connecting tunnels or flanges. The simple interlocking clip and wedge design makes this process quick and easy. To remove the molded-in partitions in the enclosure sidewalls, simply score the perimeter of the partition with a razor knife then knock out the partition. To attach flanges and tunnel adapters, interlock clips at the bottom, then secure at the top with wedges. Some flanges have molded-in knockouts designed to accept Rose+Bopla cable grips.

Depending on the application, the flange openings can be configured with either blind, threaded or connecting flanges.

## Polycarbonate Modular Flange System 1700



**1701:** The 1701 model is the smallest of the units. This unit has two side flange openings.

170mm/6.69" L x 134mm/5.28" W x 130mm/5.12" H, 20mm Opaque Lid  
170mm/6.69" L x 134mm/5.28" W x 130mm/5.12" H, 20mm Clear Lid



**1702:** This is an intermediate size in the Polycarbonate Modular Flange System. The unit is square and has four flange openings.

170mm/6.69" L x 170mm/6.69" W x 130mm/5.12" H, 20mm Opaque Lid  
170mm/6.69" L x 170mm/6.69" W x 130mm/5.12" H, 20mm Clear Lid



**1703:** This is an intermediate size in the Polycarbonate Modular Flange System. This unit is rectangular and has four flange openings.

269mm/10.59" L x 170mm/6.69" W x 130mm/5.12" H, 20mm Opaque Lid  
269mm/10.59" L x 170mm/6.69" W x 130mm/5.12" H, 20mm Clear Lid



**1704:** This is an intermediate size in the Polycarbonate Modular Flange System. The unit is square and has four flange openings.

269mm/10.59" L x 269mm/10.59" W x 130mm/5.12" H, 20mm Opaque Lid  
269mm/10.59" L x 269mm/10.59" W x 130mm/5.12" H, 20mm Clear Lid



**1705:** This is the largest of the Polycarbonate Modular Flange Units. This unit is rectangular and has six flange openings.

540mm/21.26" L x 269mm/10.59" W x 130mm/5.12" H, 20mm Opaque Lid  
540mm/21.26" L x 269mm/10.59" W x 130mm/5.12" H, 20mm Clear Lid

**1706:** This is an intermediate size in the Polycarbonate Modular Flange System. This unit is rectangular and has four flange openings.

441mm/17.36" L x 269mm/10.59" W x 130mm/5.12" H, 20mm Opaque Lid  
No clear lid version available in this size.

## Polycarbonate Modular Flange System 1700

Polycarbonate Modular Flange System 1700							
Type	Part Number	Description	Flanges & Tunnels Accepted	Length (Inches/mm)	Width (Inches/mm)	Height (Inches/mm)	Drawing Page #
1701	17011000	Enclosure with standard opaque lid	2 Version 1	6.69 / 170	5.28 / 134	5.12 / 130	17-80
	17011010	Enclosure with standard clear lid	2 Version 1	6.69 / 170	5.28 / 134	5.12 / 130	17-80
1702	17021000	Enclosure with standard opaque lid	4 Version 1	6.69 / 170	6.69 / 170	5.12 / 130	17-80
	17021010	Enclosure with standard clear lid	4 Version 1	6.69 / 170	6.69 / 170	5.12 / 130	17-80
1703	17031000	Enclosure with standard opaque lid	4 Version 1	10.59 / 269	6.69 / 170	5.12 / 130	17-80
	17031010	Enclosure with standard clear lid	4 Version 2	10.59 / 269	6.69 / 170	5.12 / 130	17-80
	17031100	Enclosure with tall opaque lid	4 Version 1	10.59 / 269	6.69 / 170	5.12 / 130	17-80
1704	17041000	Enclosure with standard opaque lid	4 Version 1	10.59 / 269	10.59 / 269	5.12 / 130	17-80
	17041010	Enclosure with standard clear lid	4 Version 1	10.59 / 269	10.59 / 269	5.12 / 130	17-80
	17041100	Enclosure with tall opaque lid	4 Version 2	10.59 / 269	10.59 / 269	5.12 / 130	17-80
1705	17051000	Enclosure with standard opaque lid	6 Version 1	21.26 / 540	10.59 / 269	5.12 / 130	17-80
	17051010	Enclosure with standard clear lid	6 Version 1	21.26 / 540	10.59 / 269	5.12 / 130	17-80
1706	17061000	Enclosure with standard opaque lid	4 Version 1	17.36 / 441	10.59 / 269	5.12 / 130	17-80



Polycarbonate 1700 Modular Flange  
with Clear Lid



Polycarbonate 1700 Modular Flange  
with Standard Opaque Lid



# Polycarbonate Flange

**1701/1702/1703/1704/1705/1706**

**External Dimensions: L170 x W134x H130 mm**

**Page 1-20**

Standard Features
<ul style="list-style-type: none"> <li>• Captive quick release lid in glass filled polycarbonate.</li> <li>• Neoprene gasket.</li> </ul>
Accessories
<p><b>1702,1703,1704,1705,1706</b></p> <ul style="list-style-type: none"> <li>• 17004200 Internal Mounting Clips (set of 4).</li> <li>• 10031104 External Brackets (set of 4).</li> <li>• 17005500 Internal Hinges (set of 4).</li> <li>• 10062100 Grounding Strip.</li> <li>• 10035003 Internal Mounting Boss Inserts (set of 10).</li> <li>• 17004100 Wedges (set of 10)</li> <li>• 17004200 Angle brackets (set of 4)</li> </ul> <p><b>1701</b></p> <ul style="list-style-type: none"> <li>• 17016000 Internal Mounting Plate.</li> <li>• 10061704 TS 32 Rail.</li> <li>• 10061724 TS 35 Rail.</li> <li>• 17003100 Flange, Version 1.</li> <li>• 17003600 Tunnel Adapter, Version 1.</li> </ul> <p><b>1702</b></p> <ul style="list-style-type: none"> <li>• 17026000 Internal Mounting Plate.</li> <li>• 10061704 TS 32 Rail.</li> <li>• 10061724 TS 35 Rail.</li> <li>• 17003100 Flange, Version 1.</li> <li>• 17003600 Tunnel Adapter, Version 1.</li> </ul> <p><b>1703</b></p> <ul style="list-style-type: none"> <li>• 17036000 Internal Mounting Plate.</li> <li>• 10061701 TS 32 Rail.</li> <li>• 10061721 TS 35 Rail.</li> <li>• 17003200 Flange, Version 2.</li> <li>• 17003400 Flange, Version 2, 19 x PG9 / PG13.5.</li> <li>• 17003500 Flange, Version 2, 16 x PG11 / PG16.</li> <li>• 17003300 Flange, Version 2, 10 x PG9 / PG13.5, 4 x PG11 / PG16, 2 x PG21 / PG29.</li> <li>• 17003600 Tunnel Adapter, Version 1.</li> </ul> <p><b>1704</b></p> <ul style="list-style-type: none"> <li>• 17046000 Internal Mounting Plate.</li> <li>• 10061702 TS 32 Rail.</li> <li>• 10061722 TS 35 Rail.</li> <li>• 17003200 Flange, Version 2.</li> <li>• 17003400 Flange, Version 2, 19 x PG9 / PG13.5.</li> <li>• 17003500 Flange, Version 2, 16 x PG11 / PG16.</li> <li>• 17003300 Flange, Version 2, 10 x PG9 / PG13.5, 4 x PG11 / PG16, 2 x PG21 / PG29.</li> <li>• 17003700 Tunnel Adapter, Version 2.</li> </ul> <p><b>1705</b></p> <ul style="list-style-type: none"> <li>• 17056000 Internal Mounting Plate.</li> <li>• 10061703 TS 32 Rail.</li> <li>• 10061723 TS 35 Rail.</li> <li>• 17003200 Flange, Version 2.</li> <li>• 17003400 Flange, Version 2, 19 x PG9 / PG13.5.</li> <li>• 17003500 Flange, Version 2, 16 x PG11 / PG16.</li> <li>• 17003300 Flange, Version 2, 10 x PG9 / PG13.5, 4 x PG11 / PG16, 2 x PG21 / PG29.</li> <li>• 17003700 Tunnel Adapter, Version 2.</li> </ul> <p><b>1706</b></p> <ul style="list-style-type: none"> <li>• 17066000 Internal Mounting Plate.</li> <li>• 10061725 TS 35 Rail.</li> <li>• 17003100 Flange, Version 1.</li> <li>• 17003200 Flange, Version 2.</li> <li>• 17003400 Flange, Version 2, 19 x PG9 / PG13.5.</li> <li>• 17003500 Flange, Version 2, 16 x PG11 / PG16.</li> <li>• 17003300 Flange, Version 2, 10 x PG9 / PG13.5, 4 x PG11 / PG16, 2 x PG21 / PG29.</li> <li>• 17003600 Tunnel Adapter, Version 1.</li> <li>• 17003700 Tunnel Adapter, Version 2.</li> </ul>

1701 Dimensions=170x134x130  
 1702 Dimensions=170x170x130  
 1703 Dimensions=269x170x130  
 1704 Dimensions=269x269x130  
 1705 Dimensions=540x269x130  
 1706 Dimensions=440x269x130

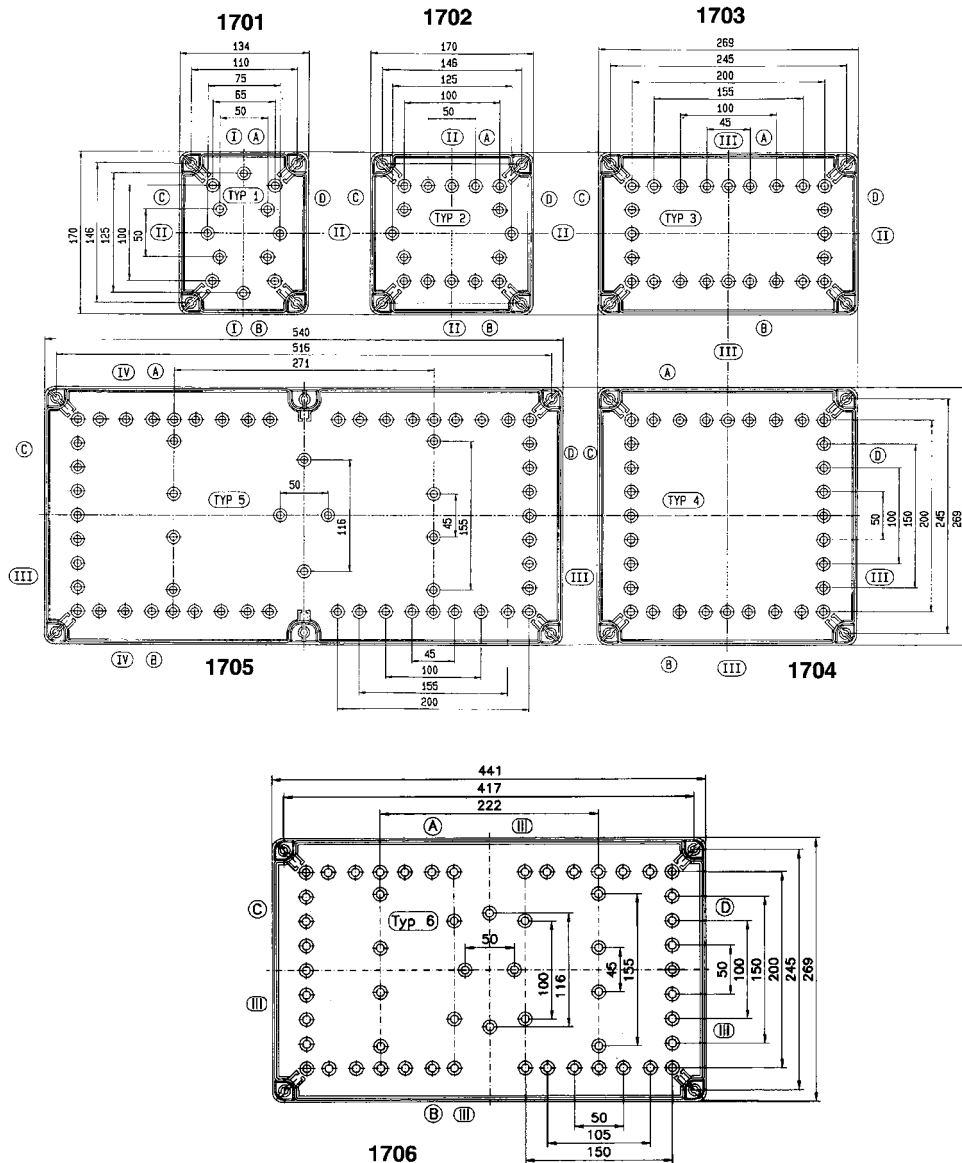

Dimensional Drawings

Standard Features

• External Bracket for 1701, 1702, 1703, 1704, 1705, 1706.

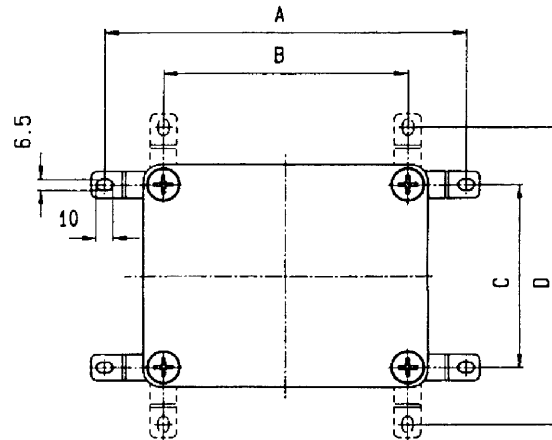

Enclosure Type	Enclosure	A	B	C	D
1701	1701	180	110	146	216
1702	1702	216	146	146	216
1703	1703	315	245	146	216
1704	1704	315	245	245	315
1705	1705	586	516	245	315
1706	1706	503	433	245	315

Standard Features

• Mounting Plate for 1701, 1702, 1703, 1704, 1705, 1706 for fastening electromechanical components.

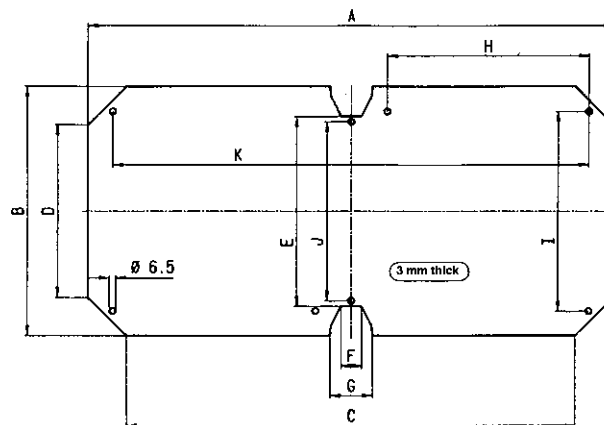

Enclosure Type	Mounting Plate #	A	B	C	D
1701	17016000	114	150	37	73
1702	17026000	150	150	72	72
1703	17036000	245	150	172	77
1704	17046000	249	249	173	173
1705	17056000	520	249	444	173
1706	17066000	421	249	345	173