



ROSE+BOPLA
ENCLOSURES

A PHOENIX MECANO COMPANY

**KSS Small
Stainless Steel
Switchgear Cabinets
Product Drawings
Last Updated 6/20/2008**

Rose+Bopla Enclosures
7330 Executive Way
Frederick, MD 21704
www.rose-bopla.com
rbinfo@pm-usa.com

Dimensional Drawings

For Secondary Services, Product Support, or To Order, Call 1-301-696-9800



TECHNICAL DATA:

- Material: Stainless steel 1.25mm; 1.403 / 304,
- Finish: Polished surface 240 grain
- Protection Classification:
Up to NEMA 4X
IP 65 to EN 60529
- Temperature Range: -40° F to +176 ° F
- Gasket Material:
Polyurethane
Silicone
EMC (on request)
- Approvals: UL Listed File #E206630

The Rose+Bopla stainless steel cabinets are second to none in reliability and appearance. These enclosures house electrical and electronic applications in medicine, food preparation, wood and

KSS Small Stainless Steel Switchgear Cabinets

pulp mills, pharmaceuticals, and numerous other industries. The material is a 304 (1.4031) 18 gauge grade stainless which is one of the most popular for bending and weldment. The seams are welded, ground smooth and then the entire cabinet is polished to a 240 grit finish. The foamed-in polyurethane gasket on the cover rests on a 15mm high lip on the bottom that is bent to an outward 10° angle so that nothing will accidentally enter the enclosure when the door is opened. This design aids in water run off so that there will be no ice build up. There is no need for costly sloped roof accessories. Off-the-shelf cabinets have an IP 65/NEMA 4X rating, stainless steel hinges and a stainless steel locking system. EMC gasketing, mounting plates, and custom sizes are available on request.

KSS Small Stainless Steel Switchgear Cabinet					
Part Number	Length (Inches/mm)	Width (Inches/mm)	Height (Inches/mm)	Weight lbs.	Drawing Page #
37012315	7.87/200	11.81/300	6.10/155	9.38	17-96
37013421	11.81/300	14.96/380	8.27/210	16.07	17-96
37014315	15.75/400	11.81/300	6.10/155	14.73	17-96
37014621	14.96/380	23.62/600	8.27/210	30.81	17-96
37015521	19.68/500	19.68/500	8.27/210	28.13	17-96
37016415	23.62/600	15.75/400	6.10/155	28.13	17-96
37016821	23.62/600	29.92/760	8.27/210	52.24	17-96

Note: Dimensions are external. Metric is the primary dimension. Inch conversions and weights are for the user's convenience and are for reference only.

Accessories shown on drawing page.

Stainless Steel Watertight

<p>Standard Features</p> <p>Cabinet with door, hinges, locking system. 4 x M6 threaded stud bolts in lid. 4 x M6 threaded weld nuts in base.</p>
<p>Accessories</p> <ul style="list-style-type: none"> • 37019901 Mounting plate for 37012315 • 37019902 Mounting plate for 37013421 • 37019903 Mounting plate for 37014315 • 37019904 Mounting plate for 37014621 • 37019905 Mounting plate for 37015521 • 37019906 Mounting plate for 37016415 • 37019907 Mounting plate for 37016821

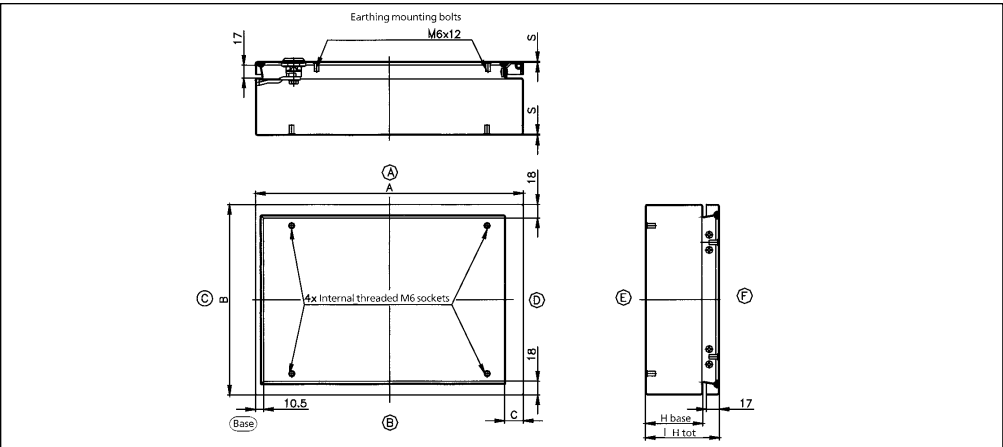

Part Number	A Length Inches/mm	B Width Inches/mm	C Inches/mm	S Inches/mm	HB Inches/mm	H tot. Height Inches/mm
37012315	7.87 / 200	11.81 / 300	.98 / 25	.05 / 1.25	5.24 / 133	6.10 / 155
37013421	11.81 / 300	14.96 / 380	.98 / 25	.05 / 1.25	7.40 / 188	8.27 / 210
37014315	15.75 / 400	11.81 / 300	.98 / 25	.05 / 1.25	5.24 / 133	6.10 / 155
37014621	14.96 / 380	23.62 / 600	.98 / 25	.06 / 1.50	7.40 / 188	8.27 / 210
37015521	19.68 / 500	19.68 / 500	.98 / 25	.05 / 1.25	7.40 / 188	8.27 / 210
37016415	23.62 / 600	15.75 / 400	.98 / 25	.06 / 1.50	5.24 / 133	6.10 / 155
37016821	23.62 / 600	29.92 / 760	.98 / 25	.06 / 1.50	7.40 / 188	8.24 / 210

<p>Standard Features</p> <p>Cabinet with door, hinges, locking system. 4 x M6 threaded stud bolts in lid. 4 x M6 threaded weld nuts in base.</p>
<p>Accessories</p> <ul style="list-style-type: none"> • 10011066 Mounting plate for 37002209 and 37002215 • 10111067 Mounting plate for 37003209 • 10011045 Mounting plate for 37004416 • 10011068 Mounting plate for 37006316 • 10011069 Mounting plate for 37006421

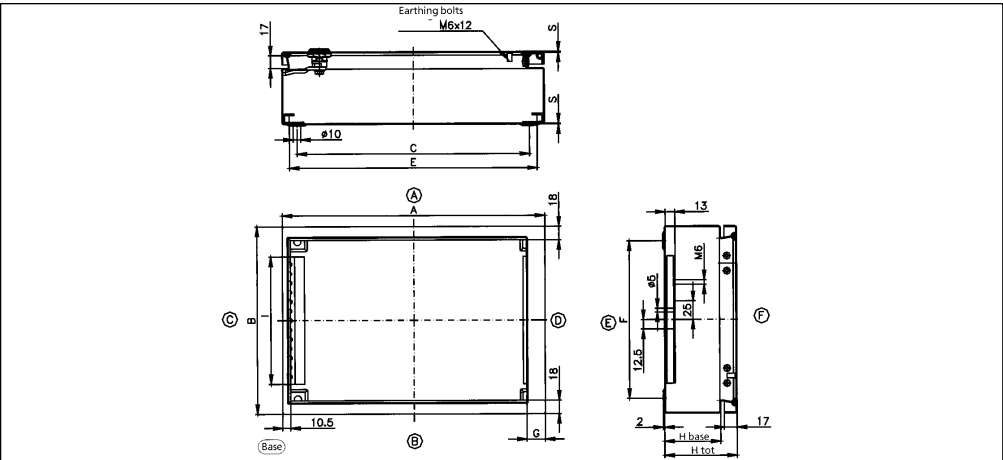

Part Number	A Length Inches/mm	B Width Inches/mm	C Inches/mm	E Inches/mm	F Inches/mm	I Inches/mm	G Inches/mm	S Inches/mm	HB Inches/mm	H tot. Height Inches/mm
37002209	7.88 / 200	9.84 / 250	6.30 / 160	7.12 / 181	8.27 / 210	6.69 / 170	.98 / 25	4.92 / 1.25	2.95 / 75	3.82 / 97
37002215	7.88 / 200	9.84 / 250	6.30 / 160	7.12 / 181	8.27 / 210	6.69 / 170	.98 / 25	4.92 / 1.25	5.31 / 135	6.18 / 157
37003209	13.78 / 350	9.84 / 250	12.20 / 310	13.03 / 331	8.27 / 210	8.27 / 210	.98 / 25	4.92 / 1.25	2.95 / 75	3.82 / 97
37003316	11.81 / 300	11.81 / 300	10.24 / 260	11.06 / 281	10.23 / 260	8.66 / 220	.98 / 25	4.92 / 1.25	5.71 / 145	6.57 / 167
37004416	14.96 / 380	14.96 / 380	13.38 / 340	14.21 / 361	13.39 / 340	11.81 / 300	.98 / 25	4.92 / 1.25	5.71 / 145	6.57 / 167
37004421	14.96 / 380	14.96 / 380	13.38 / 340	14.21 / 361	13.39 / 340	11.81 / 300	.98 / 25	4.92 / 1.25	7.68 / 195	8.54 / 217
37005316	19.68 / 500	11.81 / 300	18.11 / 460	18.94 / 481	10.24 / 260	8.66 / 200	.98 / 25	4.92 / 1.25	5.71 / 145	6.57 / 167
37006316	23.12 / 600	11.81 / 300	22.04 / 560	22.83 / 580	10.24 / 260	8.66 / 200	.98 / 25	5.90 / 1.50	5.71 / 145	6.57 / 167
37006421	23.12 / 600	14.93 / 380	22.04 / 560	22.83 / 580	13.38 / 340	11.81 / 300	.98 / 25	5.90 / 1.50	7.68 / 195	8.54 / 217